

ADVANCE

Easy Moving

19

INSTALLATION AND USE MANUAL

AUTOCLEANER





INSTRUCTION MANUAL

- Type: Filter cleaning accessory
- Model: Autocleaner
- Revision 1.0.0

AUTOCLEANER

INDEX

1	PRESENTATION	4
	1.1 Use of the manual	4
2	WARNINGS	4
3	EXPLODED PRODUCT TECHNICAL DATA AND DIMENSIONS	5
	3.1 Identification plate	7
4	PACKAGE CONTENTS	7
5	CONFORMING PRODUCT USE AND OPERATING PRINCIPLES	7
6	POSITIONING	8
	6.1 Connections	8
	6.2 installation example	9
7	POWER ON AND USE	10
8	MAINTENANCE AND END OF LIFE	10
	8.1 End of life	10
9	WARRANTY	11
10	DECLARATIONS OF CONFORMITY	12

1 PRESENTATION

Dear Customer,

We would like to thank you for choosing to purchase an our product, whose technical characteristics will surely satisfy your requirements.

Our products have been designed and built adhering to current legal regulations, following the selection of the best materials to obtain product durability and ease of use.

We therefore ask you to read the entire manual carefully and to closely follow the instructions contained therein.

1.1 Use of the manual

This manual is a document written by the manufacturer and forms an integral part of the product: it follows the sector application rules and the general rules concerning the safety of people, objects and animals.

In the event that the product is resold, given, rented or sold to others, it must always be accompanied by this manual; it is therefore recommended to use it and keep it safely for the entire working life of the product. The main objective of this manual is to make the product and its correct, safe use familiar.

No part of this manual may be reproduced or copied without the written permission of the manufacturer.

The manufacturer reserves the right to make improvements and modifications to this manual and to the product itself without obligation to give prior notice to third parties.

2 WARNINGS

- Do not use the product for improper use.
- Do not allow children near the product.
- This equipment must not be used by people (including children) with reduced physical, sensory or mental abilities, or by people without experience and knowledge, unless they are supervised or instructed to use the device by persons responsible for their safety.
- Use only original spare parts.

The Manufacturer declines any form of responsibility or guarantee if the purchaser or other individuals make even minimal changes or adjustments to the product as purchased.

3 EXPLODED PRODUCT TECHNICAL DATA AND DIMENSIONS

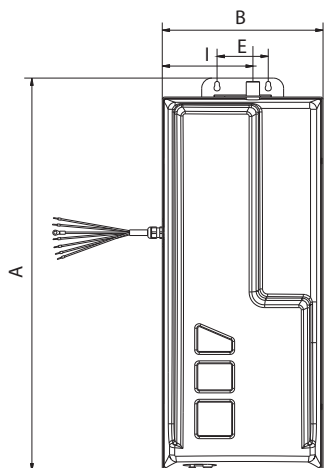
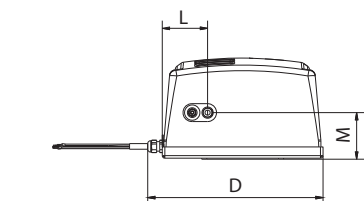

Autocleaner

Model Article	Autocleaner	
	AP3600.00.00	
Air outlet	Ø"	3/4
Air inlet	rilsan mm	10
Air pressure (in the cylinder)	bar	3,5
Safety valve	bar	8
Cylinder capacity	l	6
Optimal inlet air pressure	bar	4/5
Inlet air pressure max	bar	6
Level of protection	IP	40
Supply	V ac	220/240
Frequency	Hz	50/60
Measurement A	mm	767
Measurement B	mm	314
Measurement C	mm	197,5
Measurement D	mm	342
Measurement E	mm	100
Measurement F	mm	49
Measurement G	mm	G 3/4"
Measurement I	mm	177
Measurement L	mm	88,5
Measurement M	mm	91

English

EXPLODED

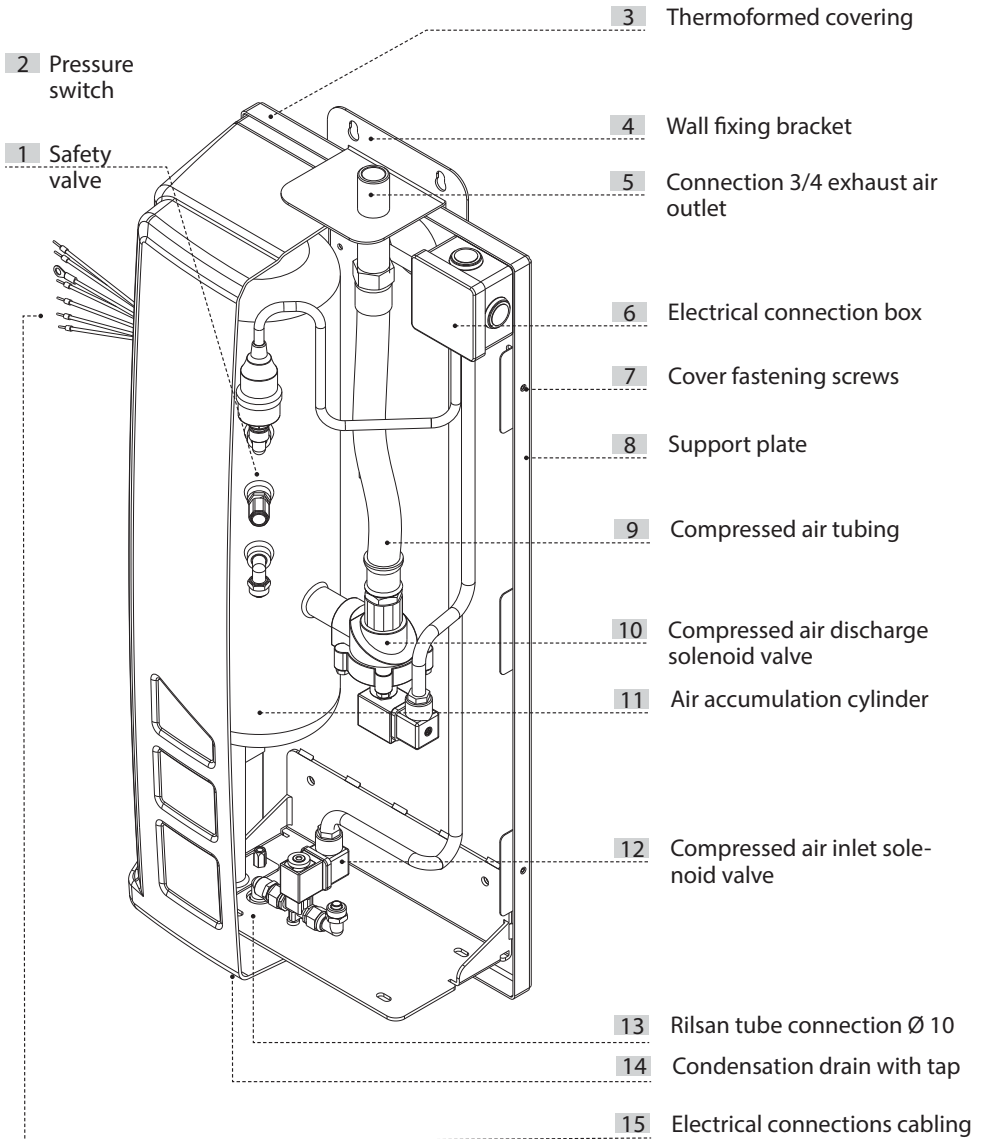

3.1 Identification plate

The CE identification plate is on the cover. Do not remove or damage the plate.

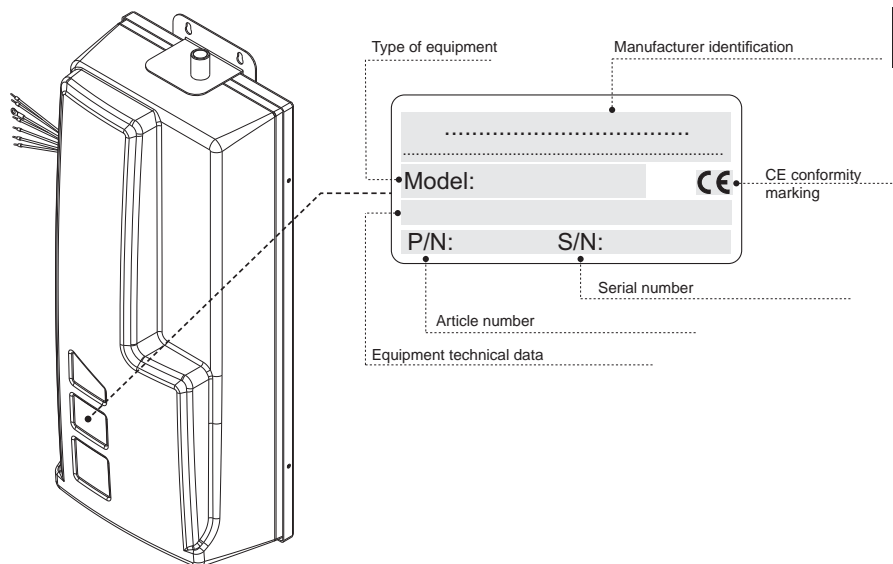

4 PACKAGE CONTENTS

After opening the package, make an inventory of that received, which will consist of:

- 1) Self-cleaning system
- 2) Installation, use and maintenance manual
- 3) Flexible hose $\frac{3}{4}$ MF length 60 cm
- 4) \varnothing 24 rubber washer

Verify that the product matches that ordered and that there is no obvious damage caused by transport. Notify the dealer immediately if this is not the case.

5 CONFORMING USE OF THE PRODUCT AND OPERATING PRINCIPLES

This product is designed for the automatic cleaning of cartridge filters present in some products, in particular in the Black Separator with autocleaning. The purpose of Self-cleaning system is to accumulate and successively release compressed air to clean the filter.

The product consists of:

- air storage cylinder
- pressure air inlet solenoid valve
- pressure air exhaust solenoid valve
- safety valve with 8bar intervention
- pressure switch for air discharge when 3.5 bar is reached
- electrical cable connection to the PLC panel

The Self-cleaning system is operated by a PLC panel on the list.

The compressed air comes from a system on the installation site (supplied at a pressure between 4 and 5 bar) entering the Self-cleaning system using a rilsan \varnothing 10 mm tube, accumulated (in about 15 seconds) and then drained through a 3/4 inch connection with the filter to be cleaned. The air flow is then conveyed at high speed through the supplied flexible hose, towards the filter to be cleaned, which must be placed at a maximum distance of 50 cm.

6 POSITIONING

The product must be installed no more than 50 cm. away from the filter to be cleaned to avoid significant cleaning force power loss. It must be fixed to the wall, or strong support by means of the bracket applied to the support plate.

6.1 Connections

The self-cleaning system must be connected to the compressed air distribution system by means of a 10 mm rilsan tube which must be inserted in the fitting at the bottom left. The compressed air supply must be at a pressure of 4-5 bar, therefore extreme caution and the use of a pressure regulator on the supply pipe and a system closing tap is recommended.

The safety valve located inside is calibrated to 8 bar.

The air outlet intended for cleaning the filter is at the top and is equipped with a 3/4 inch male connector. The electrical wiring is positioned on the left side and provides the following connections to the PLC programmable control unit (also see the wiring diagram present inside the PLC board).

Thread reference	Reference
L3/N1	230Vac self-cleaning system air cylinder inlet solenoid valve
L4/N1	230Vac self-cleaning system air outlet solenoid valve
+ / 3	Self-cleaning system cylinder pressure switch
PE	Earthing

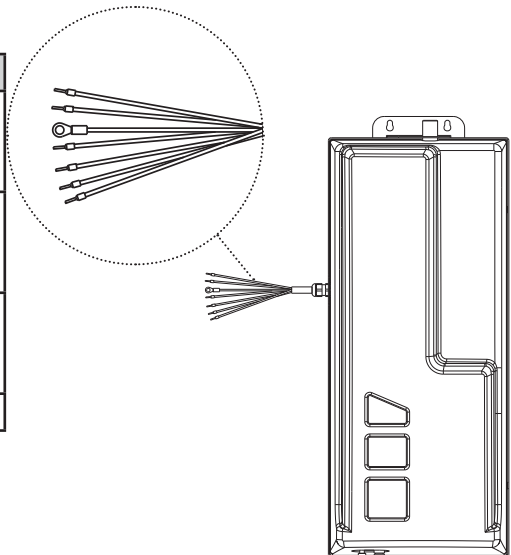

6.2 Installation example

English

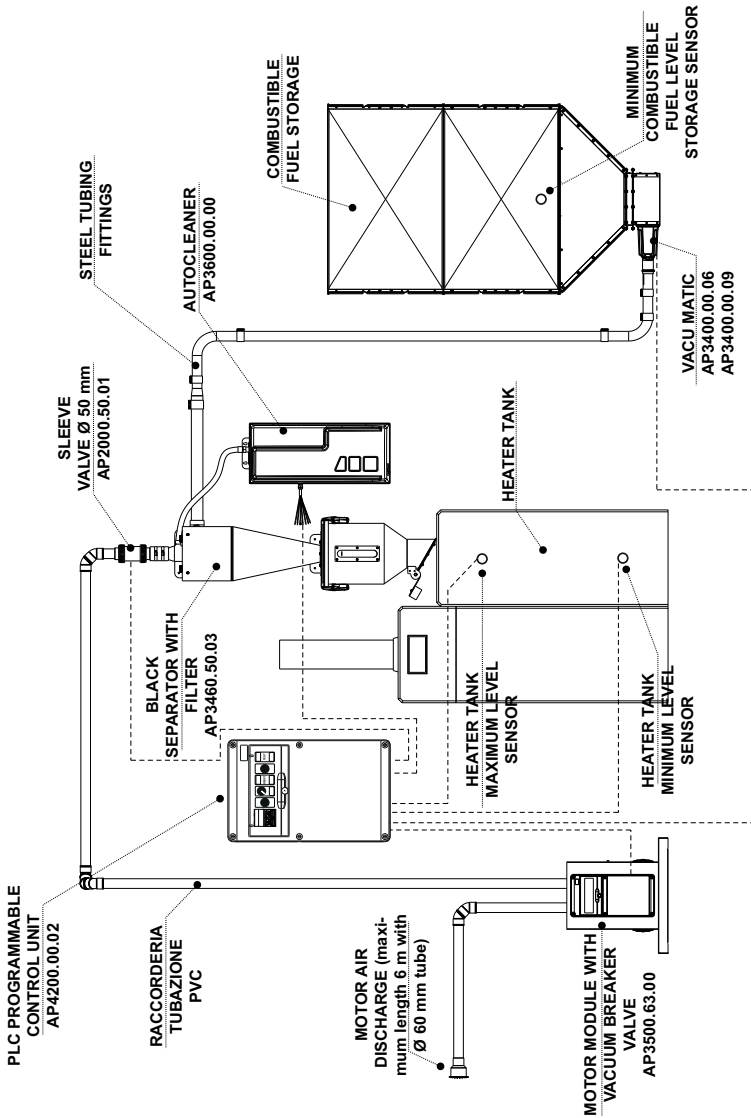

7 POWER ON AND USE

The Self-cleaning system must be electrically connected to the PLC control pane, which automatically manages the functioning of the whole system and also the filter cleaning cycles.

8 MAINTENANCE AND END OF LIFE

Self-cleaning system maintenance consists of:

- periodic purging of condensation, by opening (with a loaded cylinder) the tap specifically positioned bottom left for a few seconds
- periodic checking of the compressed air pressure at the inlet, so that it remains in the specified parameters of 4 - 5 bar.
- visual inspection of the state of wear of the cylinder (oxidized parts could compromise the seal)
- checks for any pressure loss from the fittings, including inside the equipment.

8.1 End of life

Disposal of the packaging, the accessories and the appliance must be carried out according to local regulations, guaranteeing the recycling of the raw materials they are made of.



9 WARRANTY

LIMITED PRODUCT WARRANTY CONDITIONS

The Manufacturer guarantees to the original purchaser the absence of material and workmanship defects in the product for the stated period, starting from the date of purchase. Except as prohibited by applicable law, this warranty is non-transferable and is limited to the original purchaser. This Warranty gives the purchaser specific legal rights, and the buyer can in turn claim rights that vary according to local laws.

Read all warnings and instructions before using the purchased product.

The entire responsibility of the Manufacturer and the exclusive remedy of the buyer for any breach of warranty will be at the discretion of the Manufacturer:

- (1) repair or replacement of the product, or (2) reimbursement of the purchase cost, provided that the product has been returned to the point of purchase, or to any place indicated by the Manufacturer accompanied by a copy of the purchase receipt, or detailed and dated receipt .
- (2) Shipping and handling costs may apply, except for cases where this is prohibited by applicable law.

To repair and replace the product, the Manufacturer has the right, at its discretion, to use new, reconditioned or used parts in good operating condition. Any replacement product will be guaranteed for the remainder of the original warranty period, or for any additional period of time that complies with the provisions of the law in force.

This warranty does not cover problems or damage resulting from: (1) accident, abuse, improper application, unauthorized repair, modification or disassembly; (2) maintenance operation, use not in accordance with product instructions or connection to an improper power supply voltage; or (3) use of accessories and spare parts not supplied by the Manufacturer or Authorized Center.

Valid warranty claims are usually handled through the product purchase point.

Please check this with the retailer where the product was purchased.

Requests for warranty intervention that cannot be managed through the point of purchase, as well as any other questions relating to the product, must be addressed directly to the Manufacturer. Addresses and contact information for customer service can be found on the Web.

Except as provided for by a current Act, any implied warranty or condition of merchantability or fitness for a particular use related to this product is limited to the duration of the Limited Warranty period specific to the product purchased.

Some jurisdictions do not allow limitations on the duration of implied warranties or the exclusion or limitation of incidental or consequential damages, so the above limitation may not apply to you everywhere. This Warranty gives specific legal rights to the user who may enjoy other rights that vary from state to state, according to the jurisdiction.

Consumers enjoy legal rights stipulated in national laws in force concerning the sale of products intended for consumers. These rights are not affected by the guarantees contained in this warranty.

No seller, agent or employee of the Manufacturer is authorized to make modifications, extensions or additions to this warranty.

10 DECLARATIONS OF CONFORMITY

Declaration of the absence of harmful substances

The Manufacturer declares that its products and equipment are made of materials which respect the limits established by the current health protection standards and of the environment and do not contain substances classified as SVHC (Substance of Very High Concern) in accordance with the EC Regulation 1907/2006 (REACH, ie Registration, Evaluation, Authorization of Chemicals; Registration, Evaluation, Authorization and Restriction of Chemical substances). Even if the aforesaid substances are not used in the processing cycles of the raw materials and our products, their presence can not be excluded in the order of p.p.m. (parts per million), due to micro-pollution of raw materials.



F0920557

ADVANCE
Easy Moving 